

### 1.61 - Apron/Step Flashing Installation.

- Flashing Against Vertical Sidewalls.  
Roof planes that butt against vertical walls at the end of shingle course are best protected by butynol or colour steel placed over the end of each shingle course. The method is called "Step flashing". Each step flashing is interlaced between each course of shingle.

Each step flashing is 150mm up the wall and 150mm out on the roof.

Apron flashings are one long strip of butynol or continuous colour steel and also go 150mm up the wall and 150mm out on the roof.

### Fig 1.62 - Kickout Flashing.

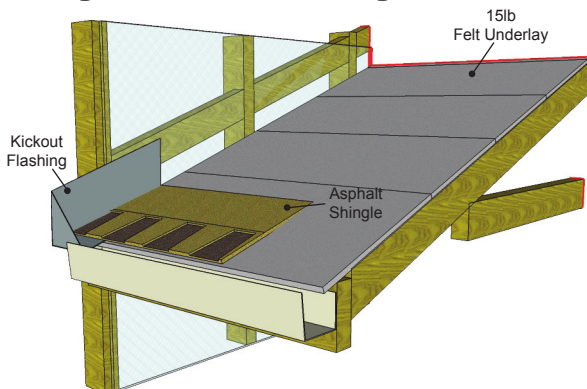

Install the metal/PVC kickout flashing prior to installation of the first asphalt shingle as shown above.

### Fig 1.63 - Butynol Stepped Flashing.

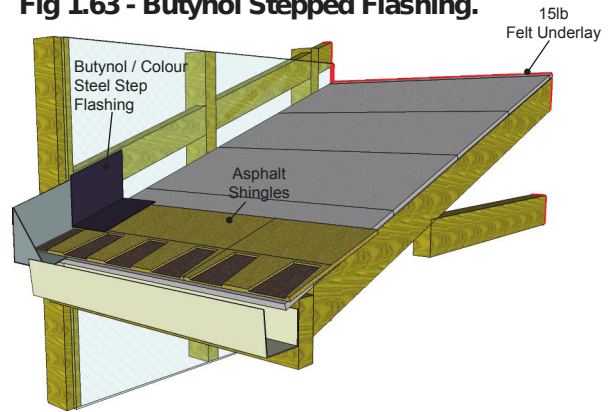

Install the first piece of butynol or colour steel flashing over asphalt shingle and kickout flashing with 200mm overlap, as shown above.

### Fig 1.64 - Subsequent Step Flashing.

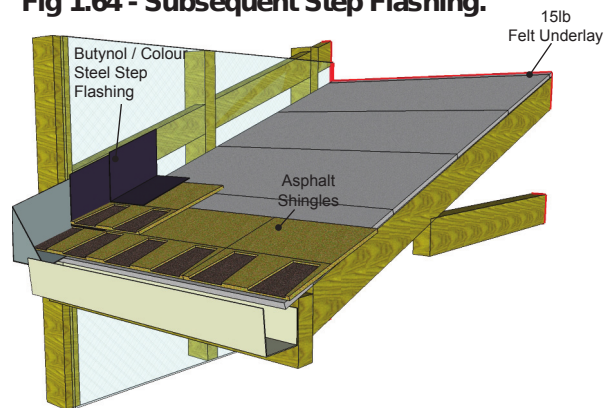

Install subsequent step flashing over the first butynol or colour steel flashing and shingle, with 200mm overlap.

### Fig 1.65 - Continue the procedures.

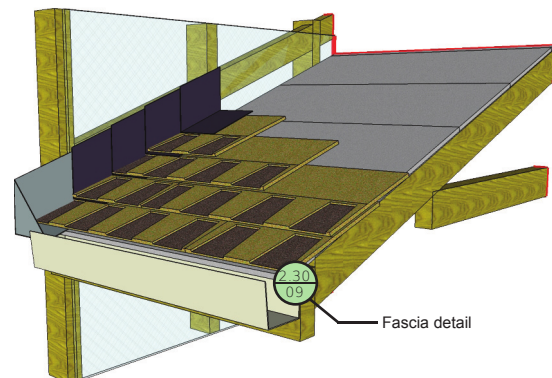

Repeat the procedures in Fig 1.62 ~ 1.64, to complete step flashing installation.

File Name:  
1.61 - Step Flashing Installation.ai

Scale:  
N/A

Drawn By:  
I.M

Date:  
28th January 2013

Drawing Name:  
Stepped Flashing Installation Guide

Sheet:  
06

**ASPHALT SHINGLE**  
ROOFING SUPPLIES LTD

Ph: 09 636 7051 | Fax: 09 636 7053 | Free Ph: 0800 261 116 | e-mail: info@asphaltshingle.co.nz  
www.asphaltshingle.co.nz | PO Box 24 676, Royal Oak, Auckland, New Zealand

\* All constructions are to comply with New Zealand Building Standards and Territorial Authority Regulations.  
\* The contractor shall verify all dimensions and levels on site before commencing work.  
\* These drawings are not to be used for construction without Territorial Authority Consent.  
\* Do not attempt to reproduce these drawings in any unlawful manner without the consent of Asphalt Shingle Roofing NZ.  
\* These drawings may be utilised in order to create working drawings for submission to a Territorial Authority or certifier for consent purposes.